



**LONSDALEMETAL Co. LTD**

London N17 9QU  
 TEL: 020 8801 4221 FAX: 020 8801 1287  
 Email: info@lonsdalemetal.co.uk  
 www.lonsdalemetal.co.uk

**DRAWING TITLE:  
 SAFEGARDTG50 EAVES DETAIL TO TIMBER**

**SCALE: 1:2 AT A4**

- 1. ALUMINIUM SNAP-ON COVER
- 2. SILICONE SEAL
- 3. PVC CO-EXTRUDED TRANSOM THERMAL LINER
- 4. INSULATION PANEL OR DGU (BY OTHERS)
- 5. ROOFING FINISH
- 6. ALUMINIUM BOX SECTION
- 7. HERMALLY BROKEN ALUMINIUM HEAD TRANSOM POWDER COATED TO RAL 9005 MATT BLACK AS STANDARD
- 8. CLOSED CELL EPDM/PVC CURB TAPE
- 9. TRANSOM FIXING SCREW
- 10. INSULATED BUILDERS CURB. MIN 70MM WIDE TO ACCOMODATE 5° PITCH
- 11. 28MM UNIT CLOSURE
- 12. PLASTERBOARD AND SKIM (BY OTHERS)

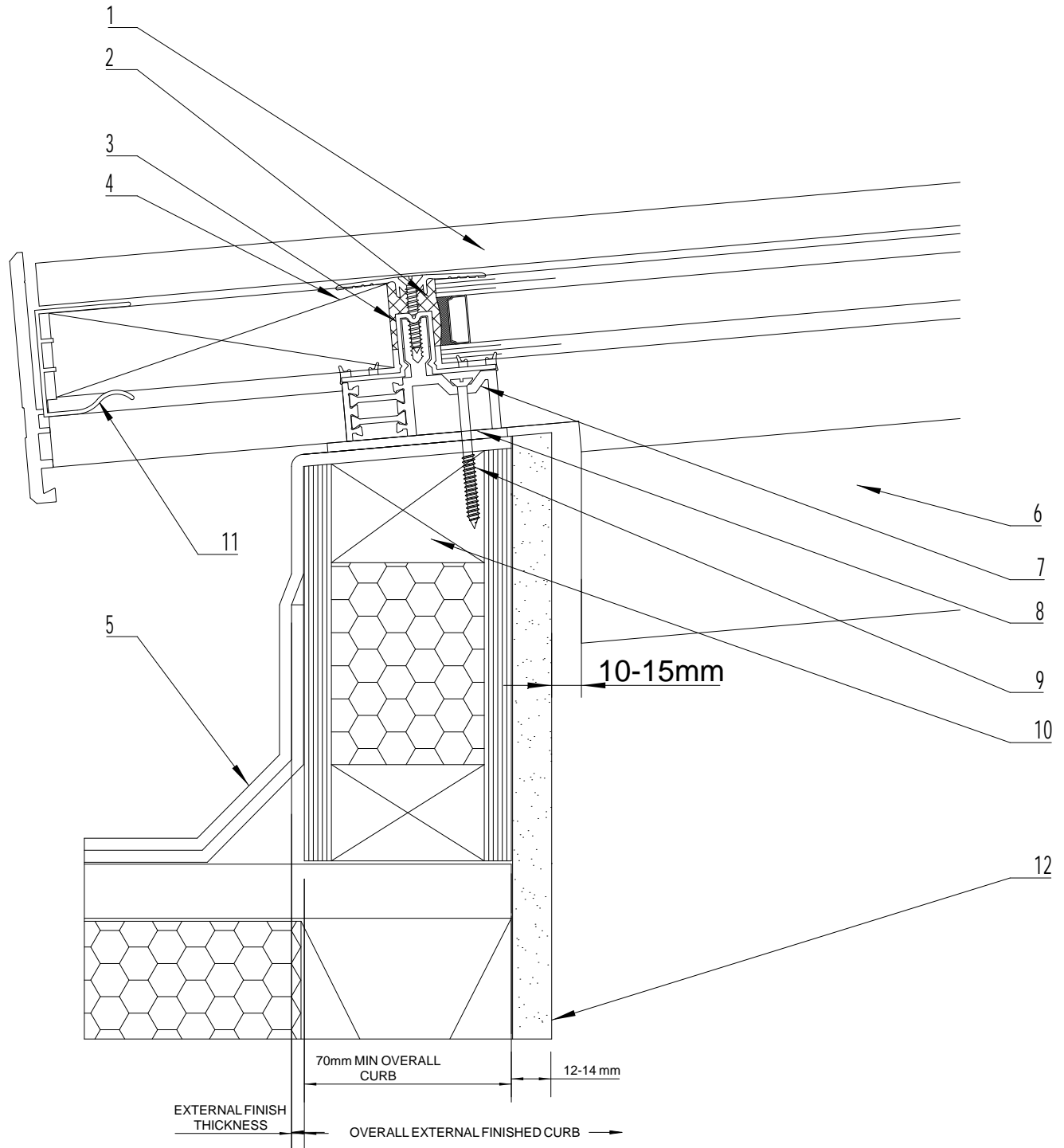

<b>PROJECT:</b> TECHNICAL CATALOGUE DETAIL SAFEGARDTG50	REV	DATE	DRAWN	VM
			DATE	07/2024
			DRG. No.	TG-83T